

# MİMARİ UYGULAMA PROJELERİNDE GÖSTERİLMESİ GEREKEN HUSUSLAR İÇİN ÇİZİM, YAZI, VE ÖLÇÜLENDİRME; ÇİZGİ, YAZI, RAKAM AYARLAMALARI İÇİN KONTROL LİSTESİ

## 1. AKS SİSTEMİ

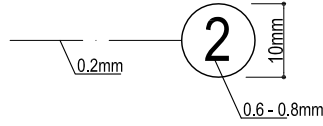

## 2. TAŞIYICI SİSTEM KOLONLARI

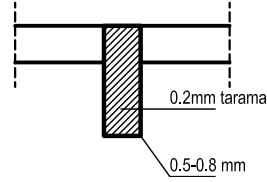

## 3. BÖLÜCÜ DUVARLAR

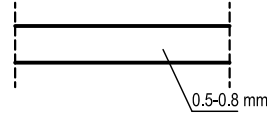

## 4. KAPILAR

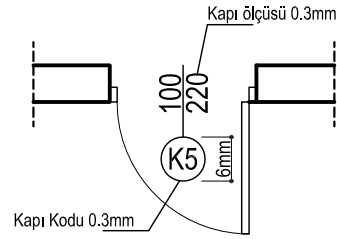

## 5. PENCERELER

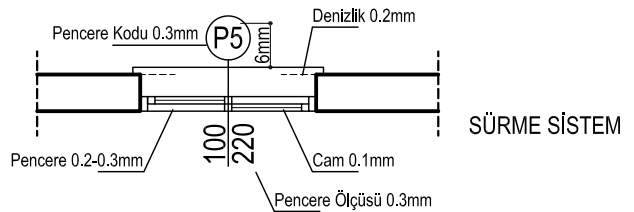
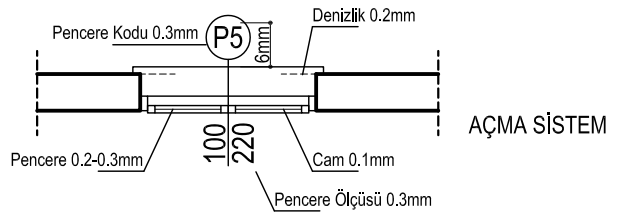

## 6. EŐİKLER

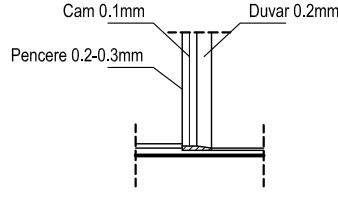

## 7. MEKAN İSİMLERİ

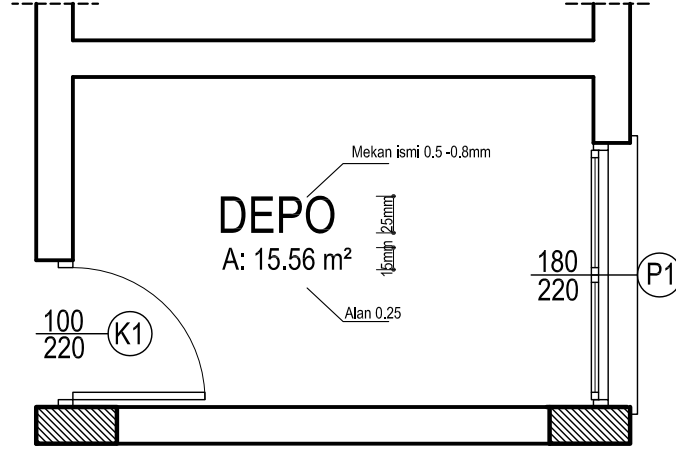

## 8. İÇ VE DİŐ MEKAN ÖLÇÜLENDİRME

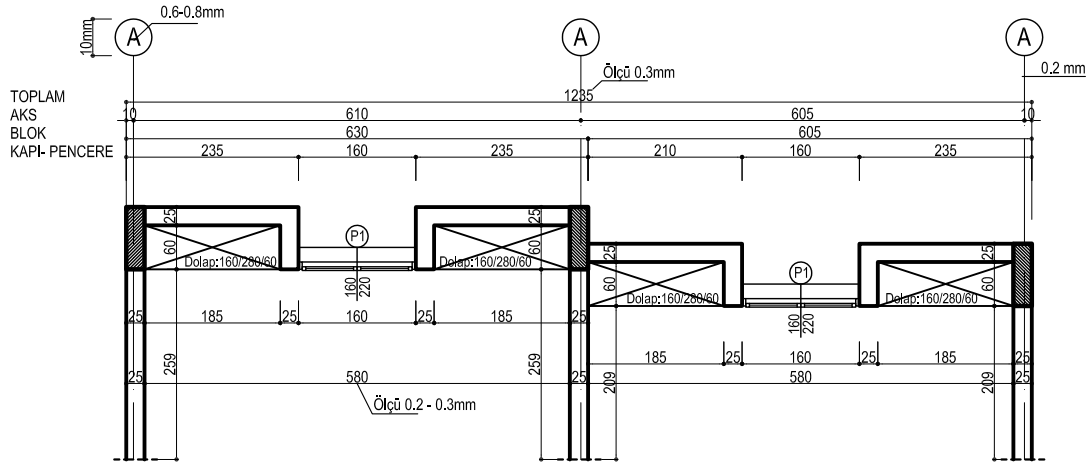

Not: İç ve Dış ölçüler santimetre cinsinden verilir

## 9. PAFTA İSMİ VE PAFTA ALANI

# ZEMİN KAT PLANI

ÖLÇEK: 1/50

A: 155 m²

1/4mm

1/5mm

1/4mm

## 10. KOTLAR

### a) PLANDA

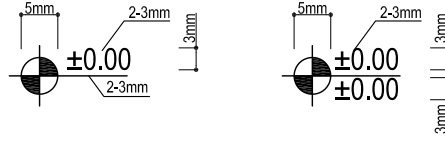

### b) KESİT VE GÖRÜNÜŞLERDE

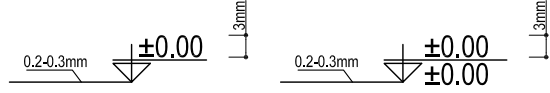

## 11. MERDİVEN ve ÖLÇÜLENDİRİLMESİ

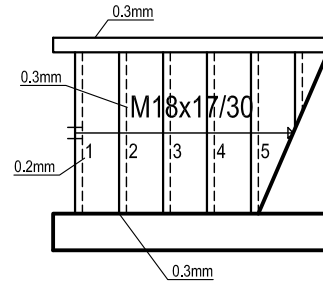

## 12. ÜSTTE TAŞAN BİNA KISIMLARI

Saçaklar, konsollar, geçitler, kemerler, kiriş ve lentolar .....Nokta Nokta'dan oluşan çizgilerle gösterilir

## 13. ALTTA KALAN YAPI ELEMANLARI VE BİNA KISIMLARI

Bodrumlar, merdivenlerin betonarme kısımları, binanın taşıyıcı sistemi ----- kesik kesik çizgilerle gösterilir.

## 14. KESİT ÇİZGİLERİ

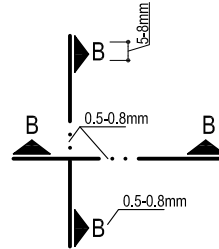

## 15. ZEMİN KATTA BİNA ÇEVRESİNDE GÖSTERİLMESİ GEREKEN YAKIN ÇEVRE ÇİZGİLERİ 0.2 mm

## 16. TERASLARDA, TERAS ÇATILARDA, OLUKLARDA, DRENAJ VE SIHHİ TESİSATIN ŞEMATİK GÖSTERİLMESİ 0.2mm

## 17. YAPIYA BAĞIMLI SIHHİ TESİSAT, DOLAP, MUTFAK DOLAPLARI, BANKOLARIN GÖSTERİLMESİ 0.3mm

## 18. BİLGİLER (MAHAL TABLOSU, PAFTA LEJANT, vs) 0.2mm-0.3mm OLARAK ÇİZİLECEKTİR.